



SPECIFICATIONS

CONTACT RATING: Dependent upon contact material see page 111.

MECHANICAL LIFE: 50,000 make-and-break cycles.

CONTACT RESISTANCE: 20 mΩ max. initial @ 2-4VDC
100mA for both silver and gold plated contacts.

INSULATION RESISTANCE: 1,000 MΩ min.

DIELECTRIC STRENGTH: 1,000 Vrms min. @sea level.

OPERATING TEMPERATURE: -30°C to 85°C.

CAP INSTALLATION FORCE: 10 lbs,max.permmissible.

MATERIALS

CASE & BUSHING : Glass filled Nylon 6/6, flame retardant, heat stabilized (UL 94v-0).

PLUNGER: Glass filled Nylon or Glass fille polyester (UL 94v-0).

SWITCH SUPPORT: Brass or steel, tin plate.

SWITCH SUPPORT RETAINER: Stainless steel.

N.O.&N.C. CONTACTS : Brass, with silver or gold plate over nickel plate.

COMMON CONTACTS & ALL TERMINALS :

Copper alloy, with silver or gold plated. (See Page 111)

TERMINAL SEAL : Epoxy.

HOW TO ORDER

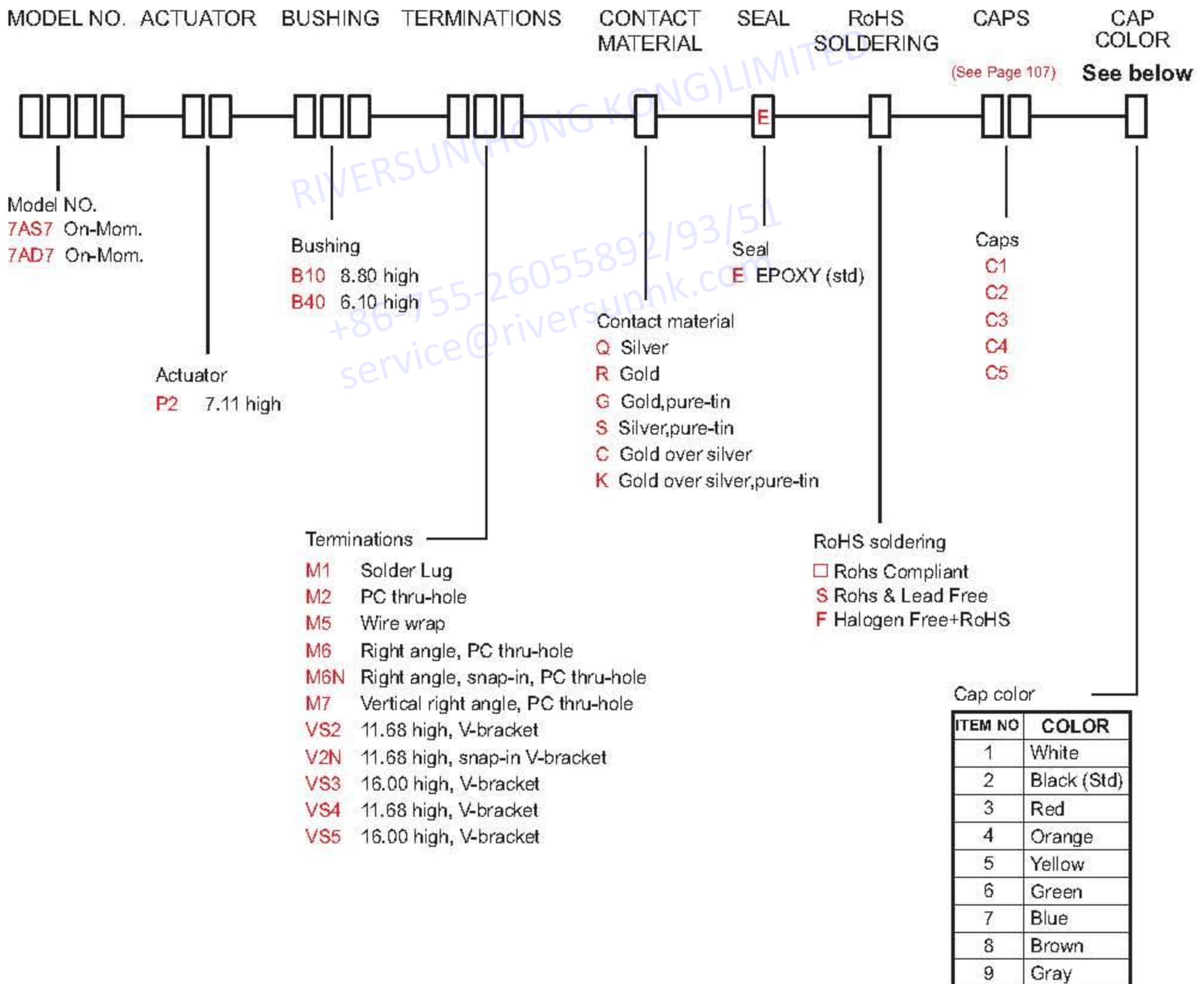

7A Series

Sealed Snap Acting Pushbutton Switches

SWITCH FUNCTION

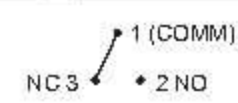
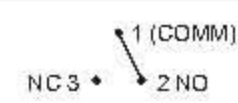
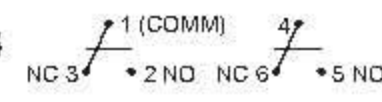
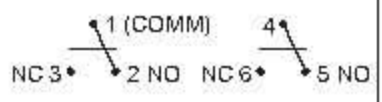
NO. POLES	MODEL NO.	SWITCH FUNCTION		CONNECTED TERMINALS / SCHEMATIC	
		POS.1	POS.2	POS.1	POS.2
SP	7AS7	ON	MOM	1-3 	1-2 
DP	7AD7	ON	MOM	1-3,4-6 	1-2,4-5 

MOM=MOMENTARY

POLE OPTIONS



SPDT

Part No. Shown : 7AS7P2B10M1QE

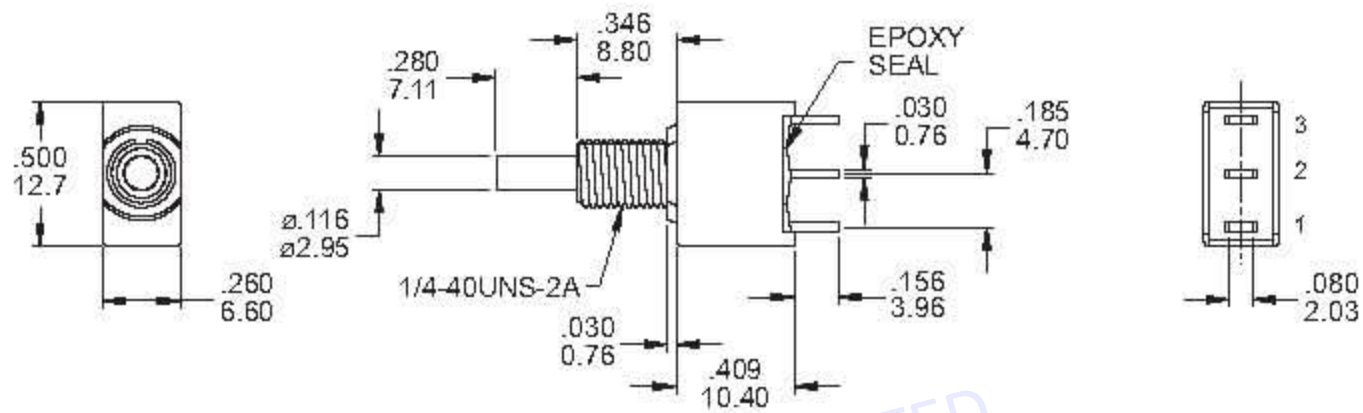

DPDT

Part No. Shown : 7AD7P2B10M1QE

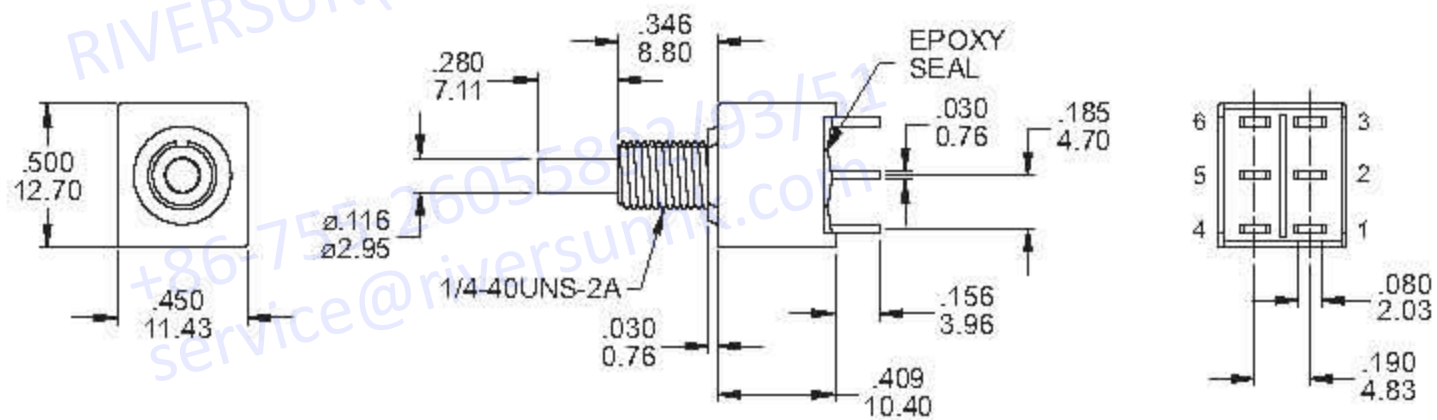

BUSHING OPTIONS

B10

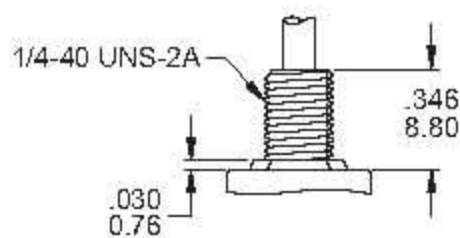

Std for M1

B40

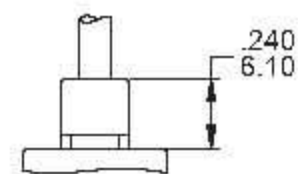

Std for M2, M6, M7, VS termination

TERMINATION OPTIONS

M1 Solder lug

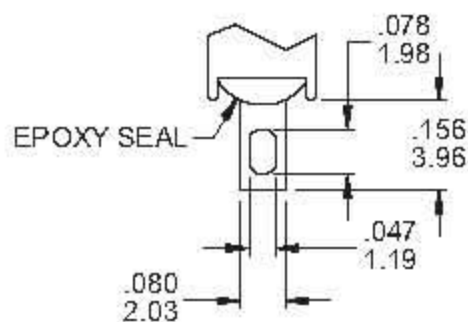

THK .030(0.76)

M2 PC Thru-hole

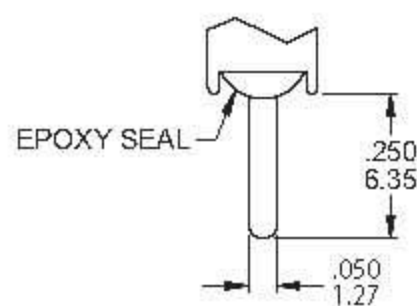

THK .030(0.76)

OTHER TERMINATION OPTIONS

M6 RIGHT ANGLE P.C. MOUNT

M7 RIGHT ANGLE P.C. MOUNT

VS2 VERTICAL BRACKET P.C. MOUNT

VS3 VERTICAL BRACKET P.C. MOUNT



7A Pushbutton Switches

M6

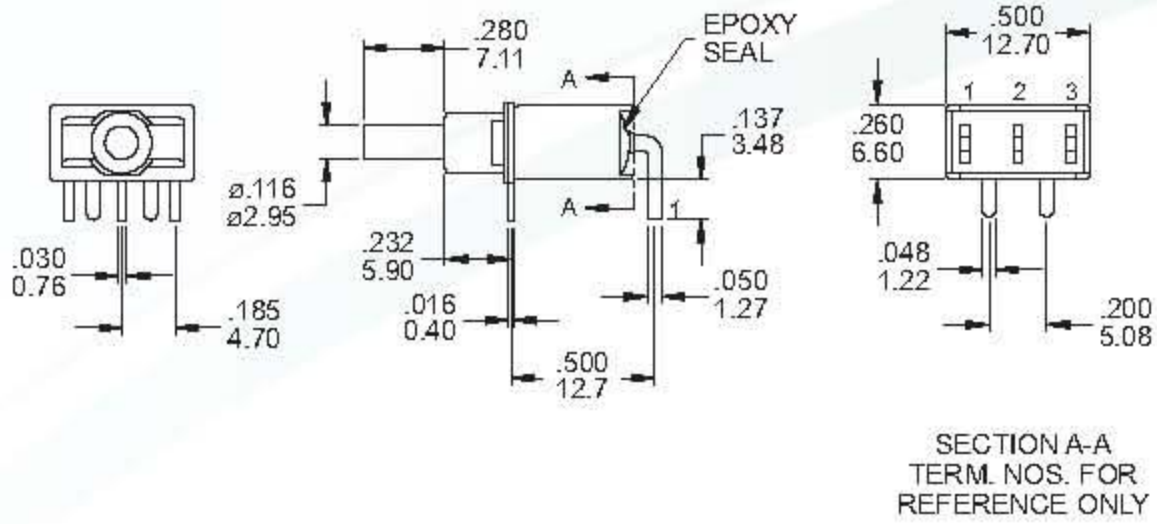

P.C. MOUNTING

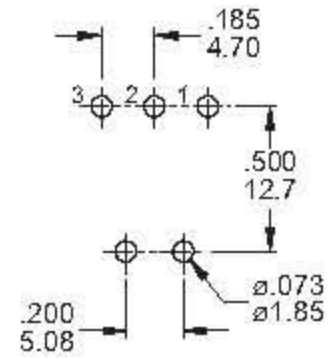

SPDT

Part No. Shown : 7AS7P1B40M6RE

SECTION A-A
TERM. NOS. FOR
REFERENCE ONLY

M6

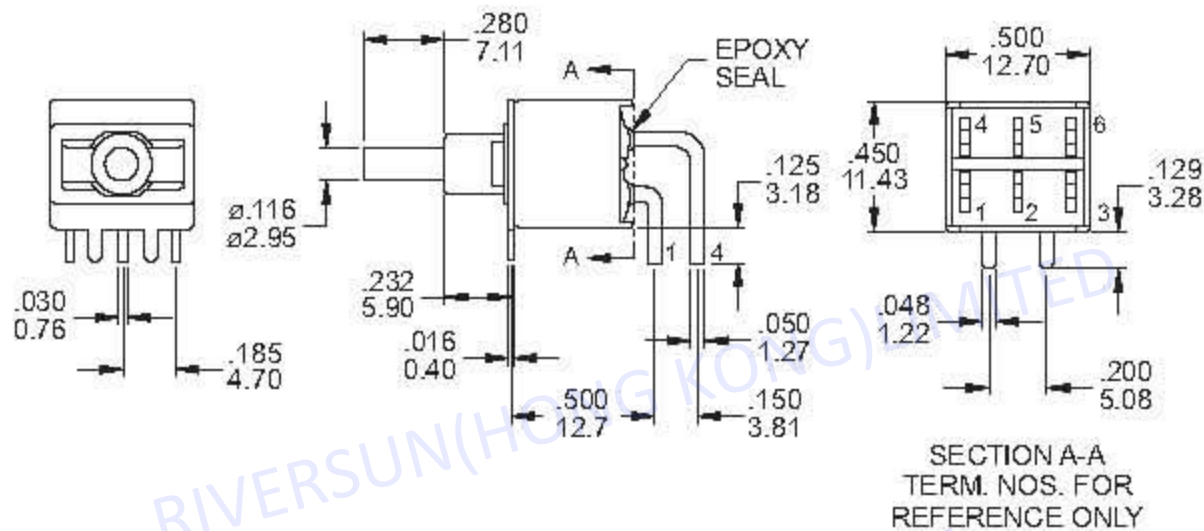

P.C. MOUNTING

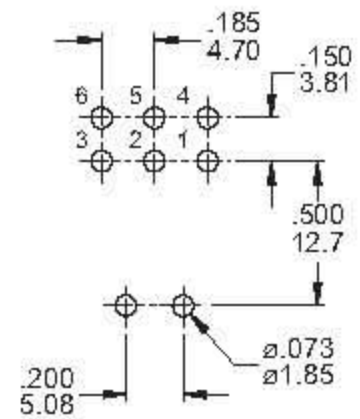

DPDT

Part No. Shown : 7AD7P1B40M6RE

SECTION A-A
TERM. NOS. FOR
REFERENCE ONLY

M7

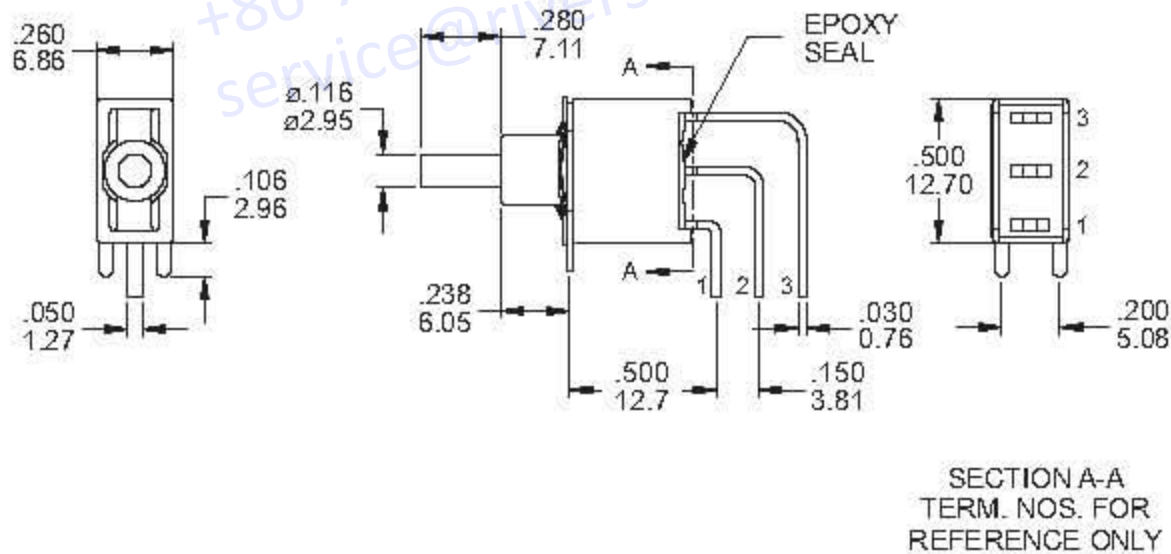

P.C. MOUNTING

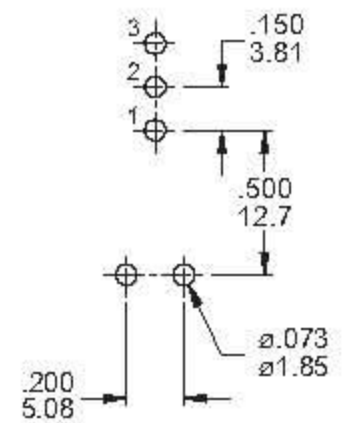

SPDT

Part No. Shown : 7AS7P1B40M7RE

SECTION A-A
TERM. NOS. FOR
REFERENCE ONLY

M7

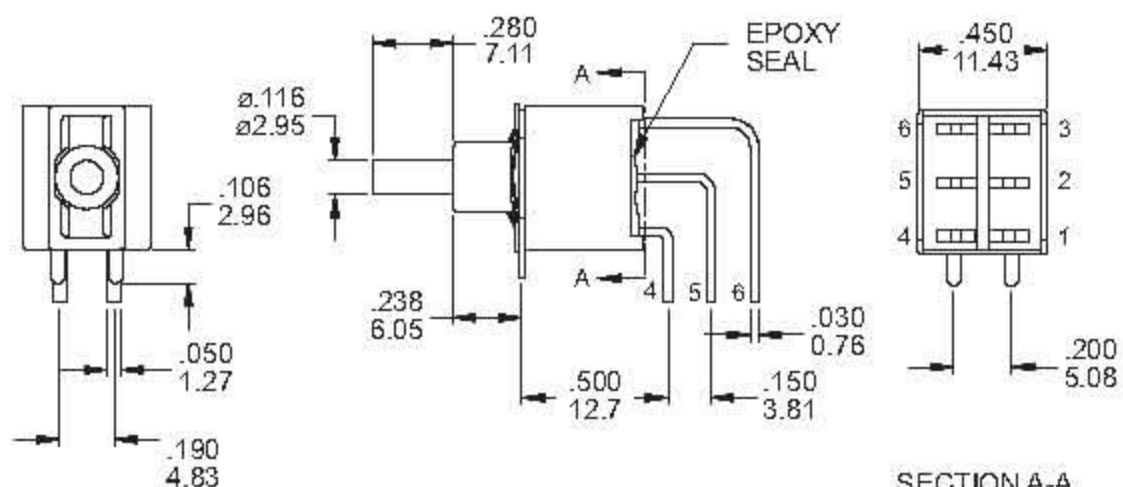

P.C. MOUNTING

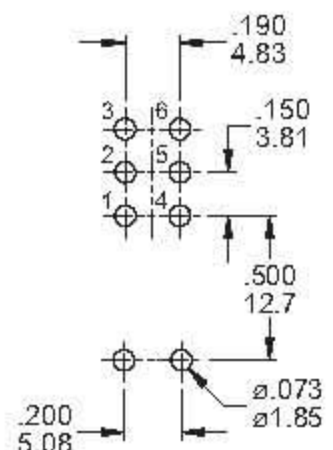

DPDT

Part No. Shown : 7AD7P1B40M7RE

SECTION A-A
TERM. NOS. FOR
REFERENCE ONLY

7A Series

Sealed Snap Acting Pushbutton Switches

VS2 - VS3

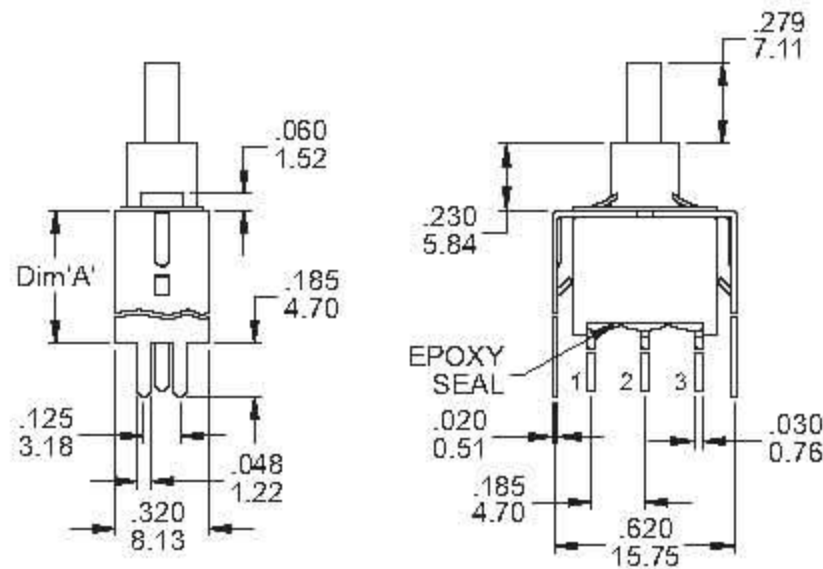

OPTION CODE	DIM. 'A'
VS2	.460 11.68
VS3	.630 16.00

P.C. MOUNTING

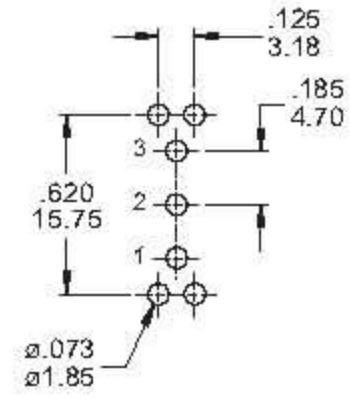

SPDT

Part No. Shown : 7AS7P1B40VS2RE

VS2 - VS3

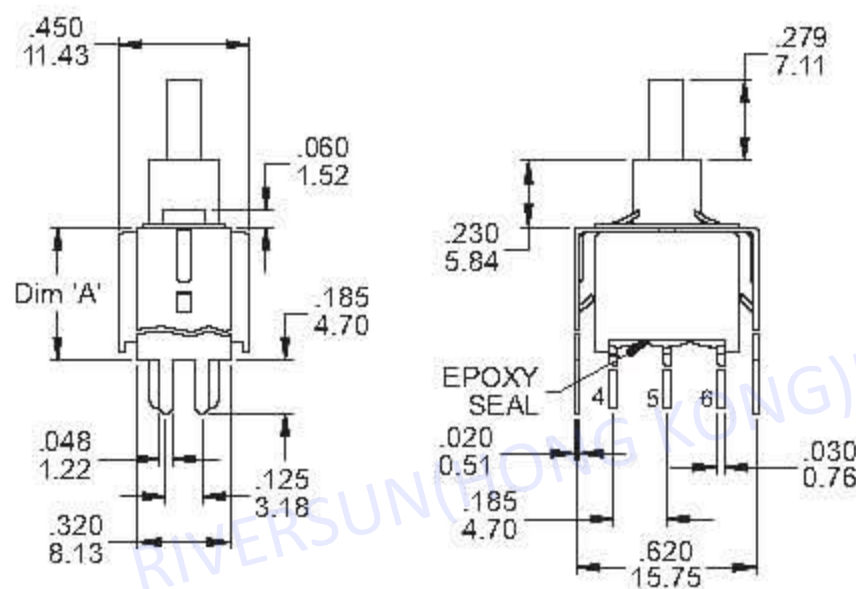

OPTION CODE	DIM. 'A'
VS2	.460 11.68
VS3	.630 16.00

P.C. MOUNTING

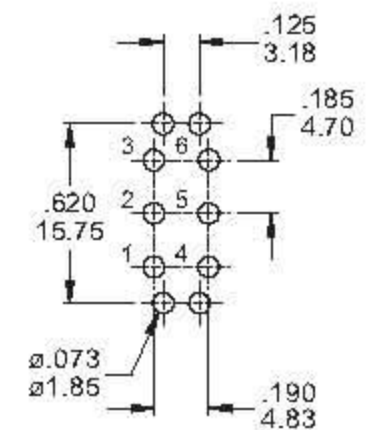

DPDT

Part No. Shown : 7AD7P1B40VS2RE

SNAP-IN TERMINATION OPTIONS

M6N

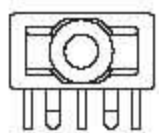

M7N

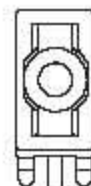

V2N

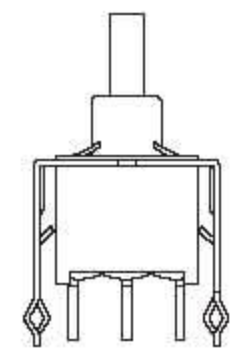
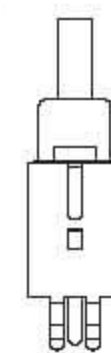

CONTACT MATERIAL OPTIONS

	CONTACT PLATING	TERMINAL PLATING	RATINGS
Q	Silver	Q = Gold flash over silver	3 Amps with resistant load @ 120VAC or 28VDC 1 Amps with resistant load @ 250VAC
S		S = Gold flash over silver, pure - tin	
C	Gold over Silver	C = Gold over silver	
K		K = Gold over silver, pure - tin	
R	Gold	R = Gold	0.4 Volt - Amps (VA) max. @ 20V max. (AC or DC)
G		G = Gold, pure - tin	

SOLDERING PROCESSES

MANUAL SOLDERING: Use soldering iron of 30 watts, controlled at 350°C approximately 5 seconds while applying solder.

WAVE SOLDERING: Recommended Soldering Temperature: 260 ± 5°C

Duration of Solder Immersion: Max 5 sec. (PCB is 1.6mm in thickness)



7A Pushbutton Switches