

# RJ SERIES

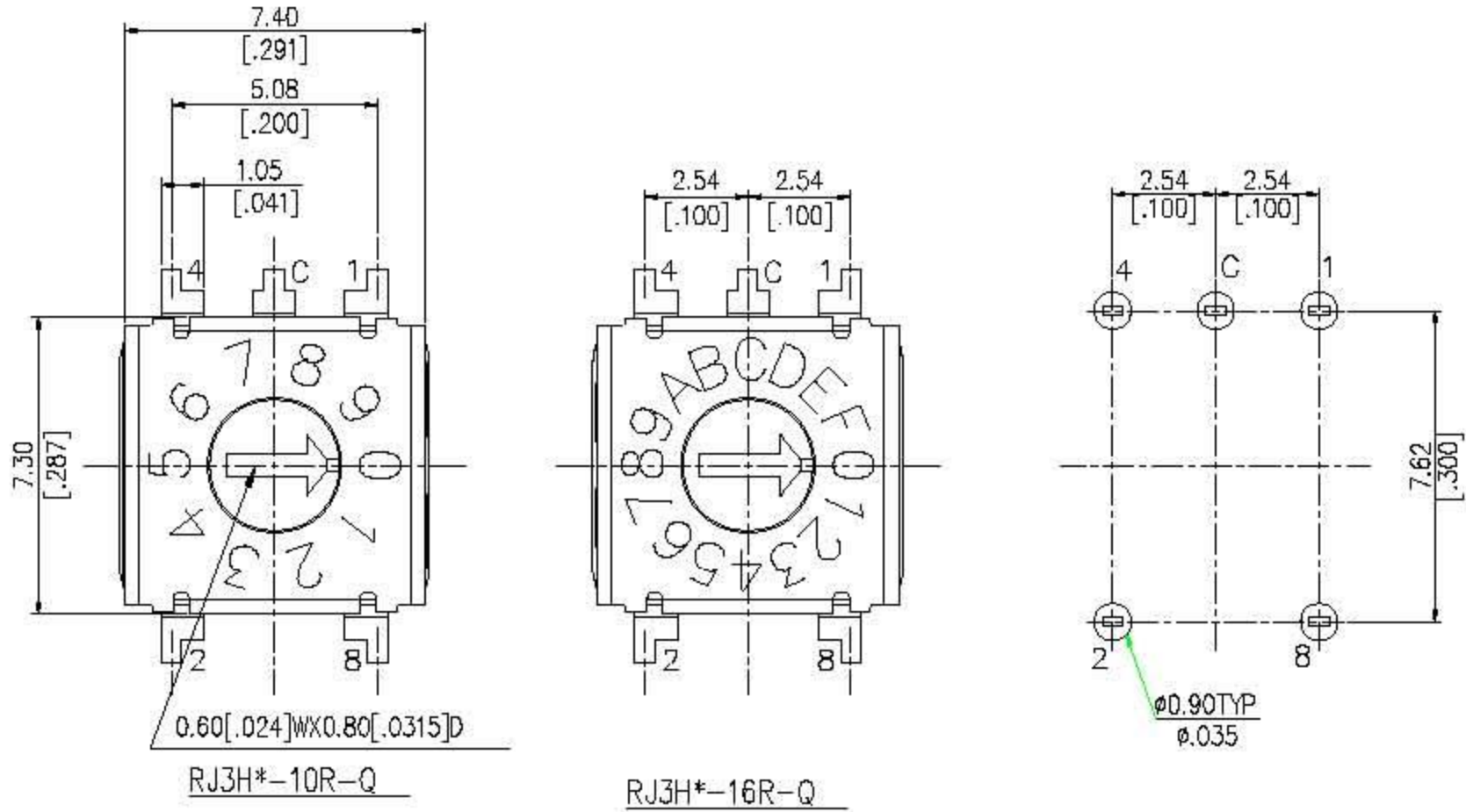

## DIMENSIONS

### RJH3 SERIES



TYPE	POSITION □□R	CODE			
		1	2	4	8
10 STEP	0	●	●	●	●
	1	○	●	●	●
	2	●	○	●	●
	3	○	○	●	●
	4	●	●	○	●
	5	○	●	○	●
	6	●	○	○	●
	7	○	○	○	●
	8	○	○	○	○
	9	○	○	○	○
16 STEP	A	●	○	●	○
	B	○	○	●	○
	C	●	●	○	○
	D	○	●	○	○
	E	●	○	○	○
	F	○	○	○	○

CIRCUIT CHART

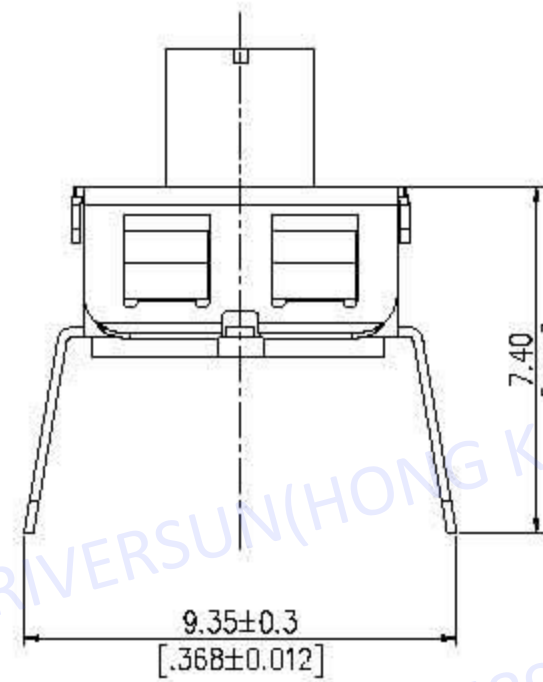
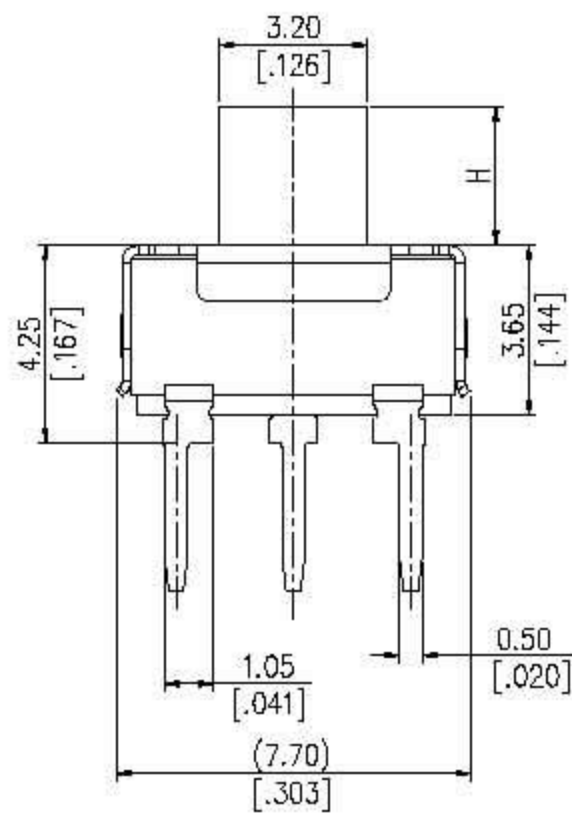

NAME	H
RJH3-10R-Q	0
RJH3-16R-Q	0
RJH3H-10R-Q	3.00 [.1181]
RJH3H-16R-Q	3.00 [.1181]

General Tolerance : ±0.2mm

### RJM3 SERIES

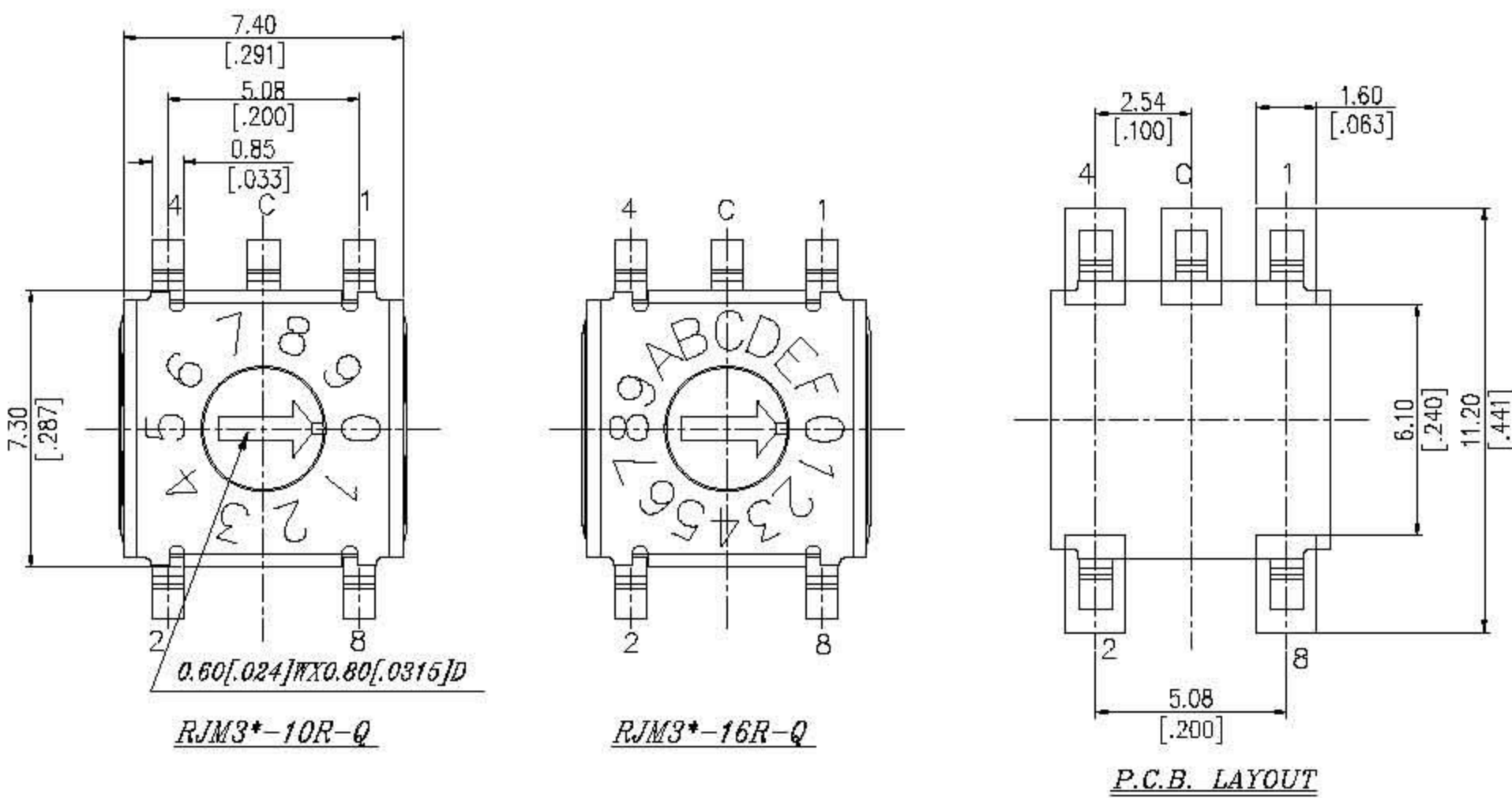

TYPE	POSITION □□R	CODE			
		1	2	4	8
10 STEP	0	●	●	●	●
	1	○	●	●	●
	2	●	○	●	●
	3	○	○	●	●
	4	●	●	○	●
	5	○	●	○	●
	6	●	○	○	●
	7	○	○	○	●
	8	○	○	○	○
	9	○	○	○	○
16 STEP	A	●	○	●	○
	B	○	○	●	○
	C	●	●	○	○
	D	○	○	○	○
	E	●	○	○	○
	F	○	○	○	○

CIRCUIT CHART

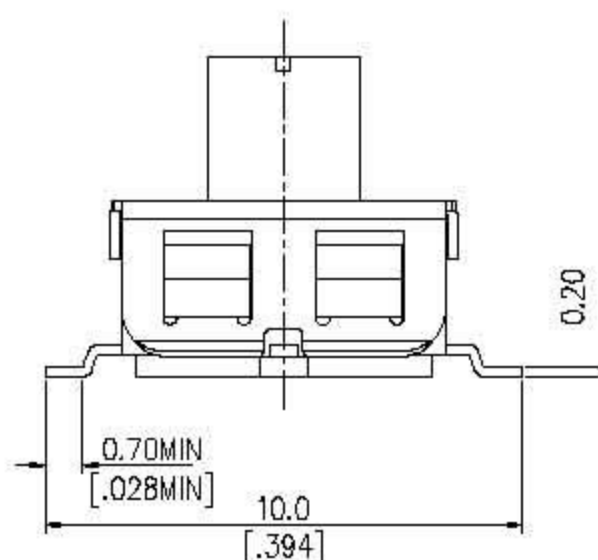
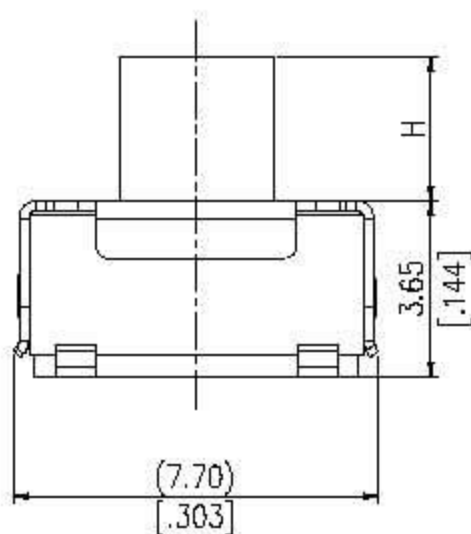

NAME	H
RJM3-10R-Q	0
RJM3-16R-Q	0
RJM3H-10R-Q	3.00 [.1181]
RJM3H-16R-Q	3.00 [.1181]

General Tolerance : ±0.2mm

# HOW TO ORDER

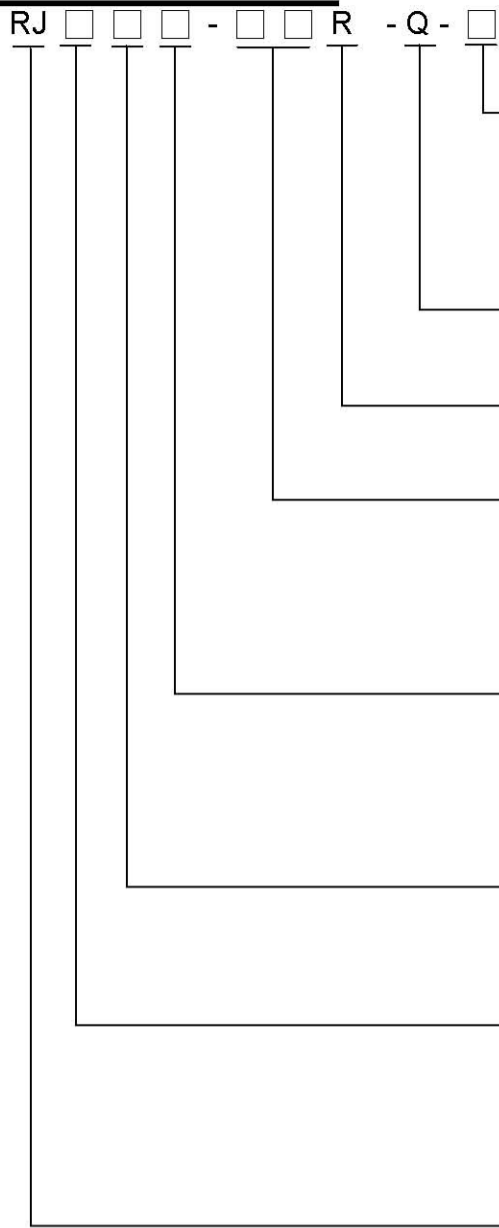

Package :

□ = Tube

T/R = Tape & Reel

Halogen Free

R = Real Codes

Number Of Steps :

10 = 10 Steps

16 = 16 Steps

Actuator Type :

□ = Recessed Actuator

H = High Actuator (3.0 mm)

Number Of Terminals :

3 = 3×2

Termination Type :

M = S.M.T

H = Through Hole

Rotary Type 7×7

## SPECIFICATIONS

### △MECHANICAL

Operating Force: 200gf-cm max.

### △ENVIRONMENTAL

Operating Temperature: -40°C to +85°C

Storage Temperature: -40°C to +85°C

### △ELECTRICAL

Electrical Life: 20,000 steps

Switching Rating: 24VDC, 25mA

Contact Resistance: (a) 100mΩ max. (initial)

(b) 200mΩ (final – after test)

Insulation Resistance: 100MΩ min. at 250VDC

Voltage Proof: 250VAC for 1 minute

## MATERIAL

△BASE : UL 94V-0 High-temp Thermoplastic

Color: Black

△ACTUATOR: UL 94V-0 High-temp Thermoplastic

Color: White

△CONTACT: Alloy copper with gold plated

△TERMINAL: Brass with gold plated

△COVER: STAINLESS STEEL

△SEAL : SILICONE RUBBER

Color: Red

△SPRING PLATE : STAINLESS STEEL

## SOLDERING PROCESS

△HAND SOLDERING : Use a soldering iron of 30 watts, controlled at (350°C) approximately max 5 seconds.

△WAVE SOLDERING: Recommended temperature at 500°F (260°C) max. 5 seconds. (For through hole type).

△REFLOW SOLDERING: When applying reflow soldering, the peak temperature of the reflow oven should be set to 260°C max.

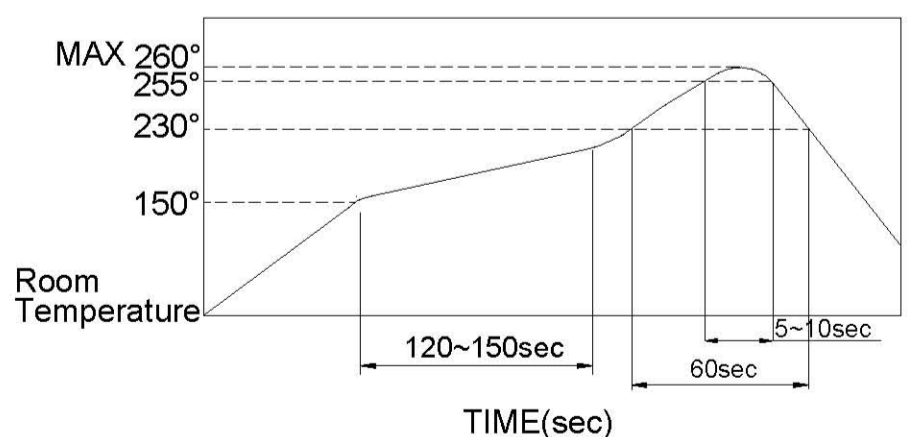

# PACKING

Part Number	Number Per Tube	Number Per Reel
RJM3-□□R	62	1200
RJM3H-□□R		650
RJH3-□□R		
RJH3H-□□R		

## RJH TYPE TUBE

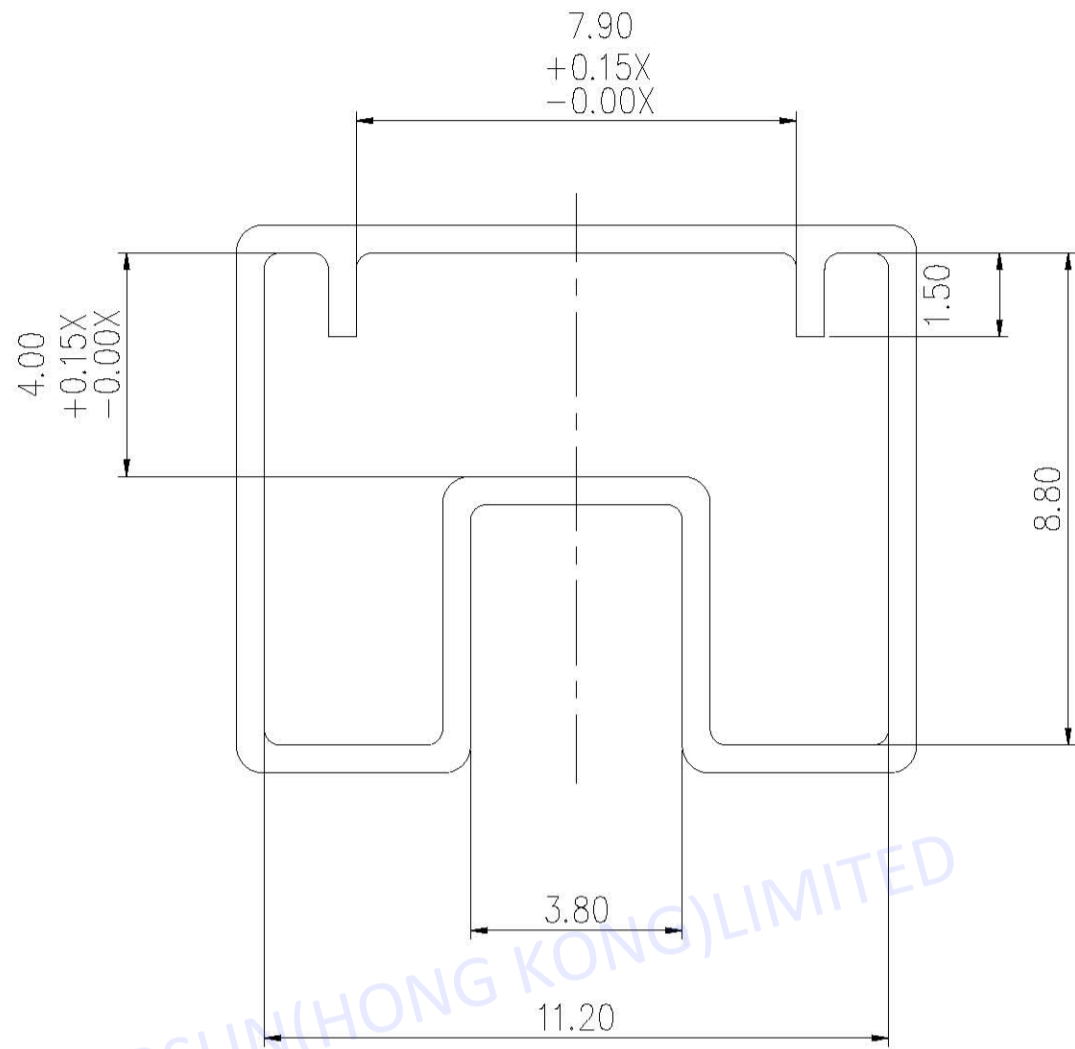

General Tolerance :  $\pm 0.2\text{mm}$

## RJH□H TYPE TUBE

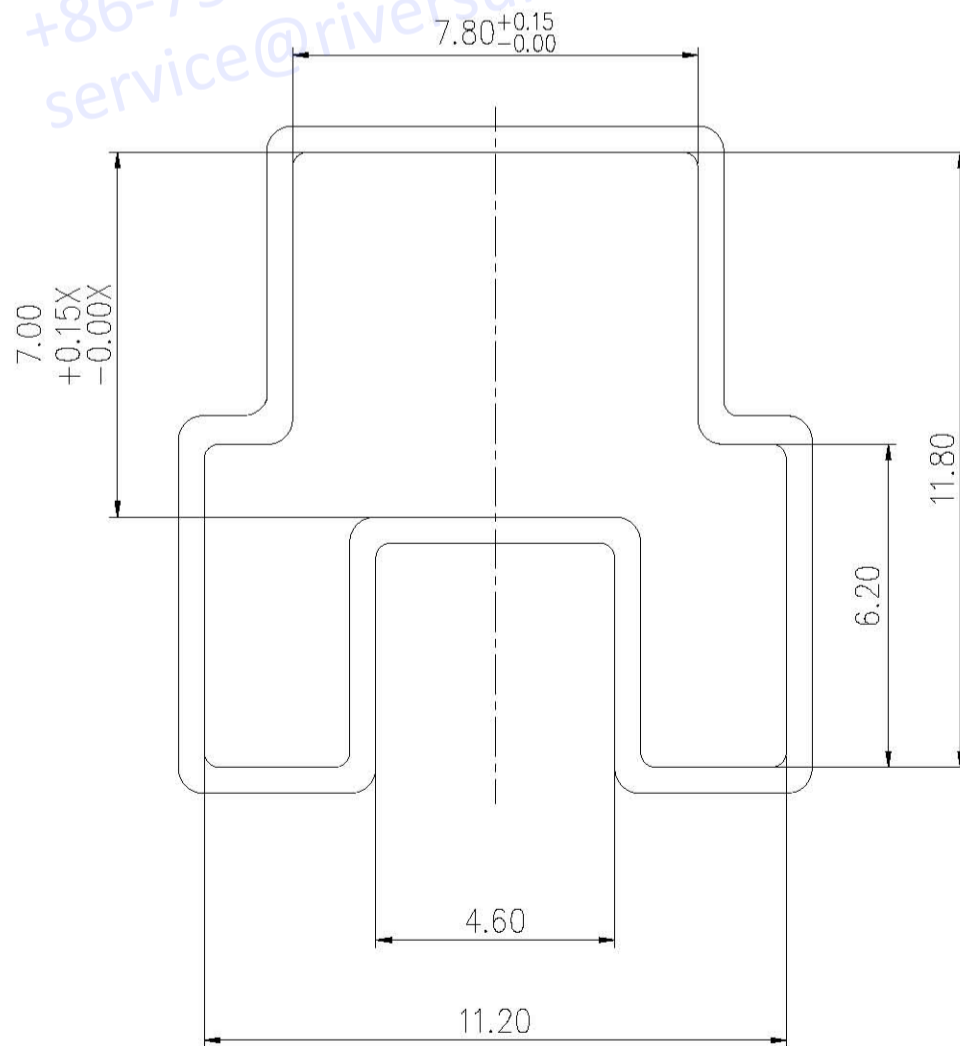

General Tolerance :  $\pm 0.2\text{mm}$



RJM TYPE TUBE

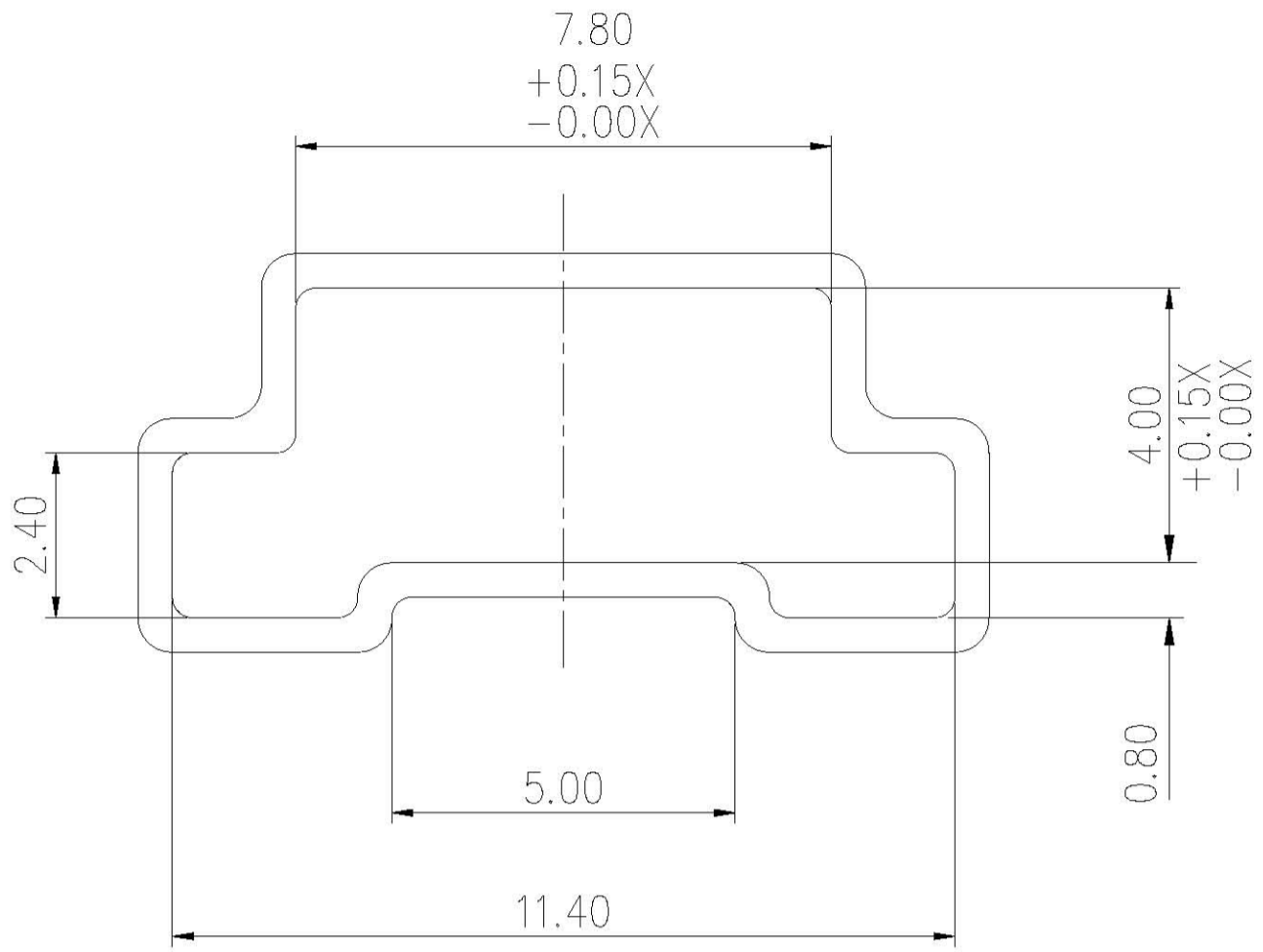

General Tolerance :  $\pm 0.2\text{mm}$

RJM□H TYPE TUBE

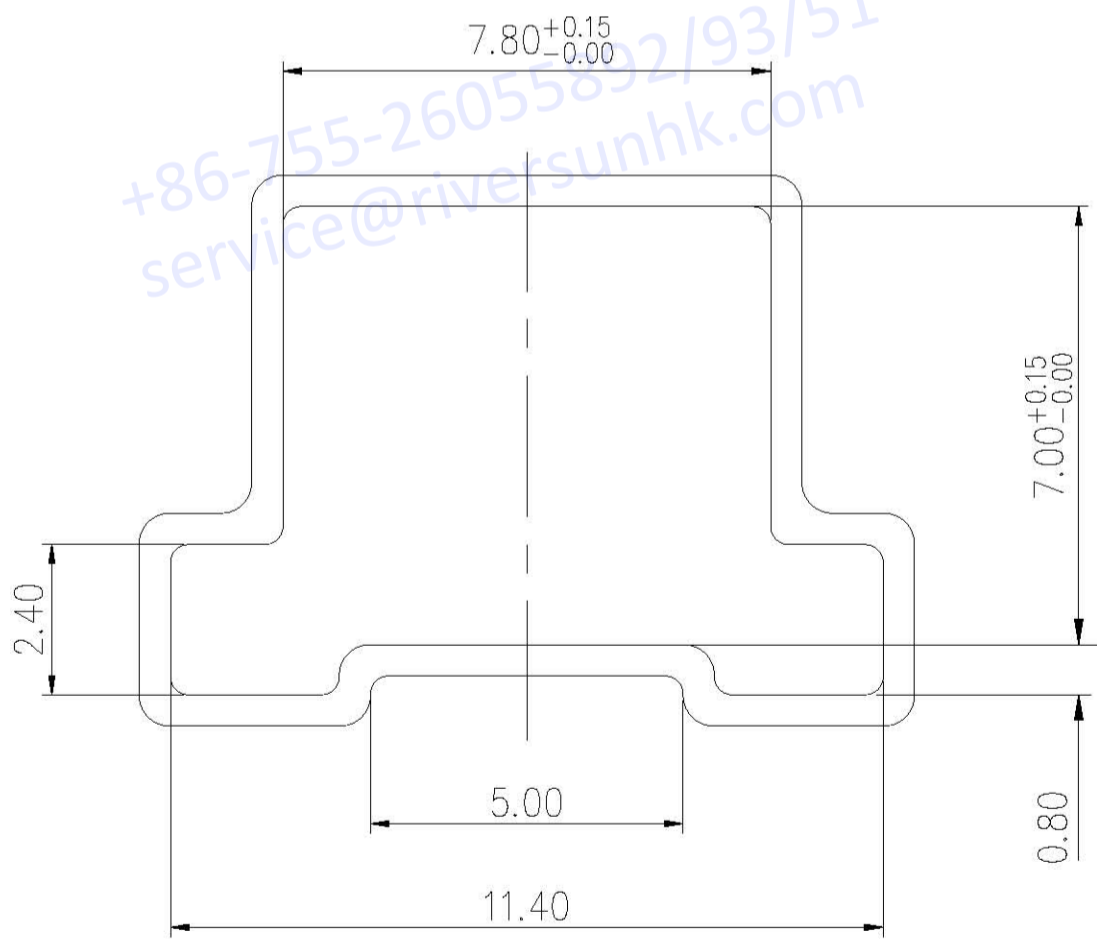

General Tolerance :  $\pm 0.2\text{mm}$